

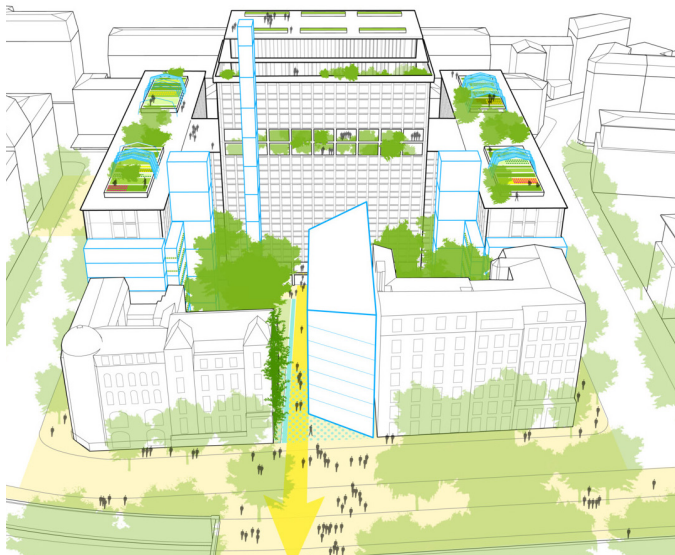

Reinventing Paris Morland

Paris, France

Our objective was to liven up this building, to make it more human via the transformation of its use, achieved by intelligent and targeted architectural interventions, like urban alchemy



Place
Paris, France

Date
2015

Client
Nexity

Cost
£52 million

Surface area
41 000m² floor area

Co-architects
Assemble
Tollila + Gilliland

Multidisciplinary team

Covea
Immobilière 3F
Artelia
Encore Heureux
Urbantech
Earnest
Scintillo
Rooms
Etic
Sciences PO
Le Perchoir
Zen Parc
La Petite Reine
Ares Services



The austere formal qualities of the Morland site represent a significant architectural challenge but also offer the opportunity to create a project that is a catalyst for urban change. We propose a flexible, mixed-use complex which is more dynamic and more efficient thanks to internal adaptations and external additions, whilst remaining sensitive to the character of the existing buildings.

The project posits a flexible armature capable of accommodating a great diversity of activities that once assembled are greater than their constituent parts. This is achieved through the proximity, the diversity, the creative interaction and shared infrastructure and amenities offered. Our proposal reflects a loose fit scheme – adaptable and evolutive – for a building housing a multiplicity of uses and lifestyles; a dynamic hive of shared activities and facilities.

The North ceremonial courtyard of the building remains largely unchanged except for the addition of an adaptable glazed pavilion, a glass theatre located within the ceremonial courtyard. This foyer connects the activities located in each of the wings that frame the courtyard and houses a variety of multi-functional activities in an “inhabited plinth”, opening up the basement to the public. The pavilion also serves as a distributor; a new route that passes through the whole site,

connecting the Boulevard Morland to the banks of the Seine. This axis opens onto the Quai Henri IV and serves to guide pedestrians to the heart of the complex, making accessible a previously impermeable urban block.

The main tower houses a “vertical village” that benefits from a generous south west facing terrace. The existing roofs are transformed to provide allotments and gardens for the residents of the flats and of the hotel. At the top of the tower, a bar-restaurant with a spectacular panoramic terrace offers extraordinary views of the city. Panoramic external lifts reveal the roofscapes of Paris as they ascend, connecting a succession of new shared spaces, accessible to all. By redistributing the vertical circulation, the existing floors are also made more efficient and more adapted to changes of use.

Our project proposed a shared, sustainable and dynamic platform which focuses on long-life, loose-fit and low-energy principles. This project delivers a diverse program of nearly 41,000m² of offices, creative space for start-ups, social and private housing, a hotel, shared amenities, workshops and retail units as well as a flexible auditorium, FabLab and nursery. This project represented a response to the ambitions of the City of Paris as part of the call for innovative proposals within the “Reinventing Paris” initiative.